

# ASSIGNMENT SALE

Molozzi Street  
Erin



See this  
property online  
Scan the QR code  
with your phone's camera



\*Images are for illustrative purposes only. Photos of actual unit not yet available.



**SAM McDADI**  
REAL ESTATE BROKERAGE

# WELCOME

Experience the best of modern living in the picturesque town of Erin, ON, with this stunning semi-detached home in the Erin Glen Community by Solmar. Situated on Molozzi Street, this spacious 1,920 sq ft home (The Chisolm, Elevation B1) offers 4 bedrooms and 2.5 bathrooms, making it an excellent choice for growing families or those who simply appreciate extra space.

Erin Glen Community provides an ideal blend of natural beauty and modern amenities, with convenient access to local schools, parks, and shops. The thoughtfully designed layout of this semi-detached home, combined with high-quality finishes, ensures a comfortable and stylish living environment. Don't miss the opportunity to be part of this vibrant community—contact us today to explore what life could be like in Erin Glen.

Closing/Occupancy: Mar 14, 2025



\*Images are for illustrative purposes only



\*Images are for illustrative purposes only



\*Images are for illustrative purposes only



\*Images are for illustrative purposes only

# FLOOR PLAN

1,920 sq ft  
 4 bedrooms  
 2 bathrooms

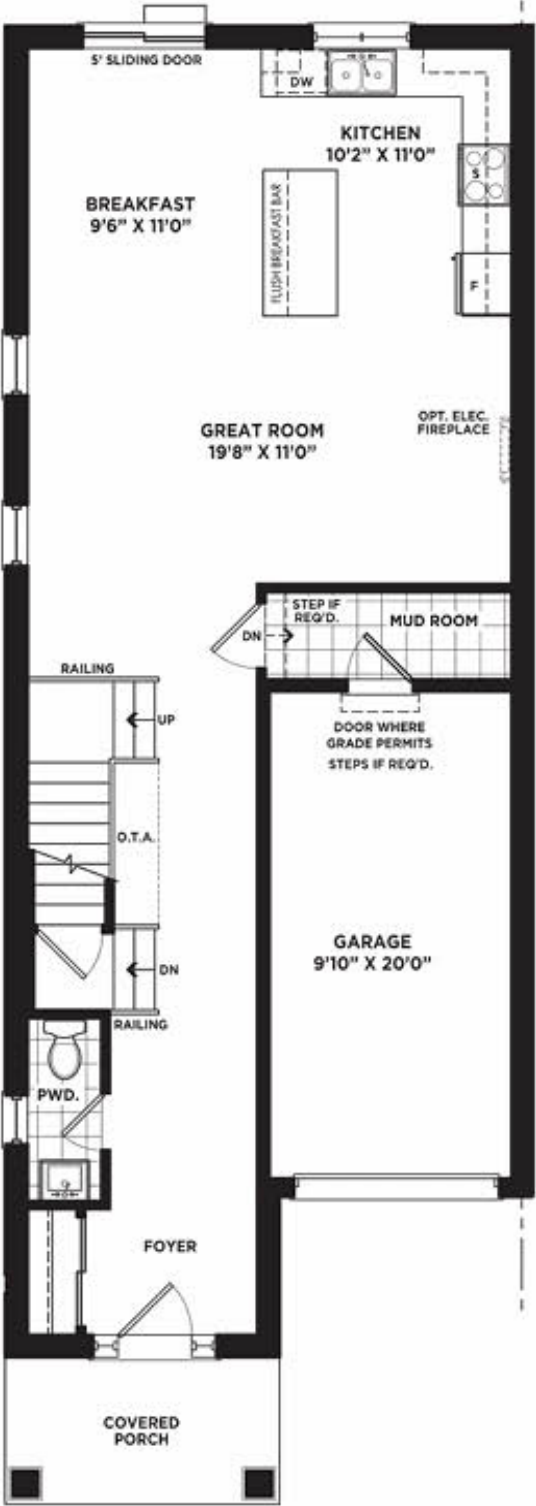

**GROUND FLOOR**  
 ELEV. A1 (ELEV. A2 Reversed)  
 Similar ELEV. B1 (ELEV. B2 Reversed)



**SECOND FLOOR**  
 ELEV. A1

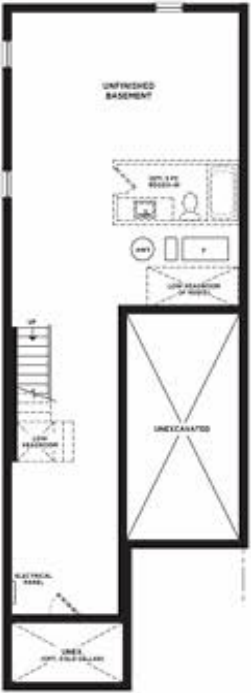

**BASEMENT**  
 ELEV. A1 & B1  
 (ELEV. A2 & B2 Reversed)

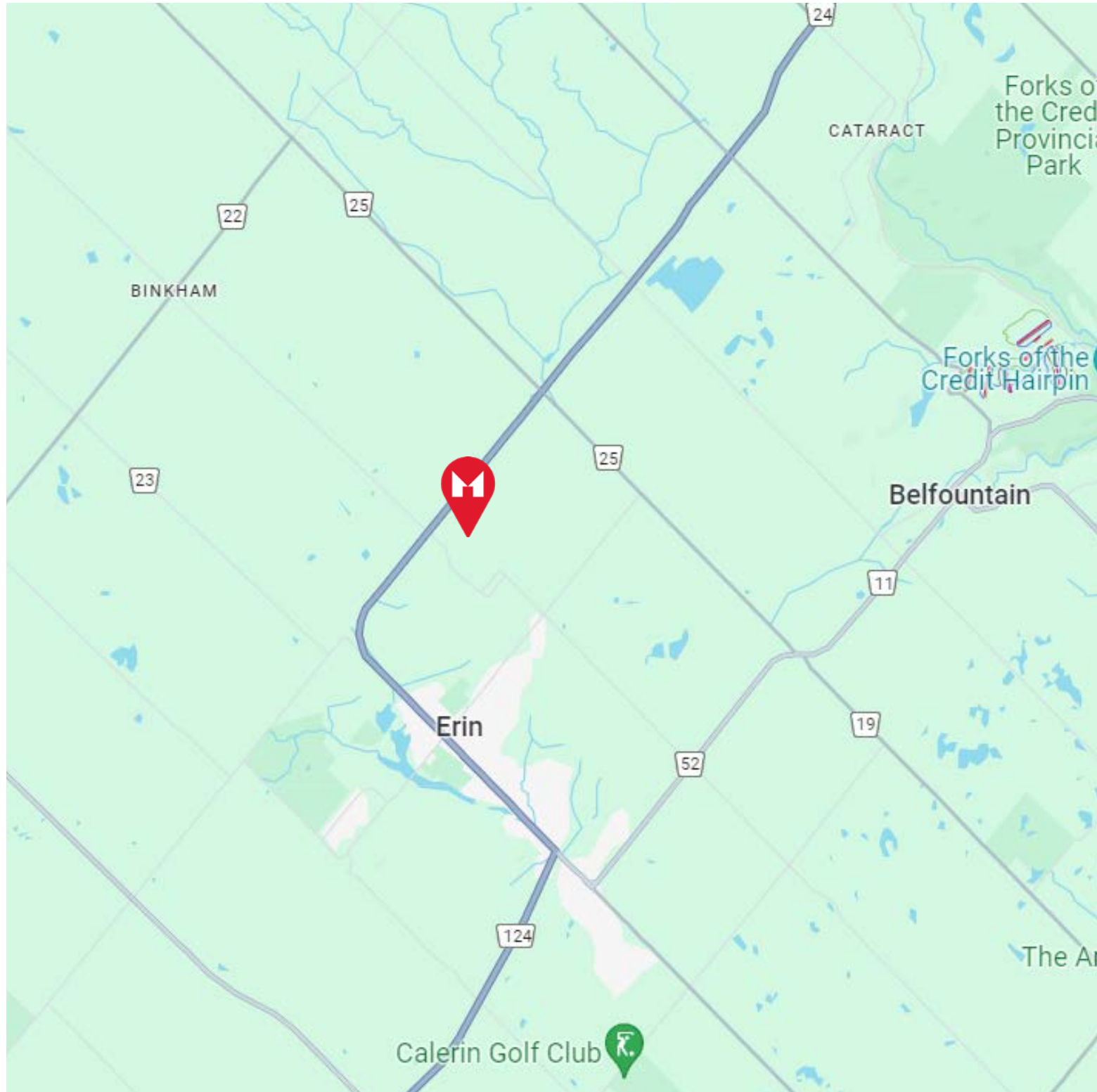

## Schools

**Erin Public School**  
185 Daniel St, Erin

**Belfountain Public School**  
17247 Shaws Creek Rd, Belfountain

**Alton Public School**  
19657 Main St, Alton

**Brisbane Public School**  
9426 Wellington Rd 124, Erin

**Erin District HighSchool**  
14 Boland Dr, Erin

**Humber College**  
275 Alder St 2nd Floor, Orangeville

## Amenities

**RBC Royal Bank**  
152 Main St, New Dundee

**TD Canada Trust**  
125 Main St, Erin

**Esso Gas Station**  
1521 Charleston Sideroad, Caledon

**LemonTree Products**  
32 Pioneer Dr #2, Erin

**Foodland**  
102 Trafalgar Rd, Hillsburgh

**Erin Heights Golf Course**  
9515 Sideroad 17, Erin

**Erin Fitness**  
5399 Wellington Rd 52, Erin

**Erin Community Centre & Arena**  
14 Boland Dr, Erin

**Rexall**  
123 Main St, Erin

**Guelph General Hospital**  
115 Delhi St, Guelph

**LCBO**  
41 Main St, Erin

**Tim Hortons**  
4 Thompson Crescent, Erin

**Westside Market Village**  
200-250 Centennial Rd, Orangeville

**Riverside Park**  
12 Church Blvd Unit 4, Erin

**Belfountain Conservation Area**  
819 Forks of the Credit Rd, Caledon

# Thank you for visiting

For more photos visit: [listings.mcdadi.com](https://listings.mcdadi.com)

All information displayed within this catalogue is believed to be accurate but is not guaranteed and should be independently verified. No warranties or representations are made of any kind.

# When you choose Team McDadi, **you help**

Team McDadi is a proud supporter of numerous charitable organizations, sports programs and community events

- ▶ Clarkson Christmas in the Village
- ▶ Clarkson Halloween in the Village
- ▶ Erindale Little League Tennis Canada
- ▶ Family Jingle and Mingle
- ▶ Heartland Dragons Minor Hockey Association
- ▶ Hoops for Her
- ▶ Mississauga Girls Hockey League
- ▶ Mississauga Santa Claus Parade
- ▶ Port Credit Buskerfest
- ▶ Princess Margaret Hospital Association
- ▶ Port Credit Skating Club
- ▶ Sick Kids
- ▶ Rouge Valley Health System Foundation and Club
- ▶ The Art of Giving
- ▶ Schizophrenia Society of Ontario
- ▶ Tennis Canada
- ▶ The Compass Food Bank
- ▶ The Mississauga Food Bank
- ▶ The Mississauga Tigers



# Sam McDadi Real Estate Brokerage **is proud to donate a portion of each sale to the**



In 2018, Team McDadi donated \$250,000 to Trillium Health Partners Foundation.  
**In 2020, we increased our pledge to donate \$1,000,000.**



**Official Real Estate Brokerage  
of the Toronto Raptors**

Sam McDadi BSc, M.B.A. Sales Representative.

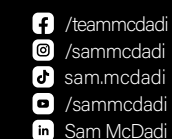

**Mississauga** | 5805 Whittle Rd #110 **905 502 1500**  
**N. Mississauga** | 1034 Clarkson Rd **905 823 1500**  
**Milton** | 1264 Main St E. **905 876 1300**  
**Oakville** | 78 Lakeshore Rd W. **905 845 1500**  
**Toronto** | 3311 Yonge St **416 544 1500**  
**Burlington** | 3-4130 Fairview Street **905 333 1100**  
**Hamilton** | 110-442 Millen Rd **905 664 5100**